



# COMMUNITY TASK FORCE

MEETING #6 | January 26, 2022

- Tour
- Thoughts since last meeting
- Needs Statements
- Discussion Questions
- Options Discussion
- Key Messages



## COMMUNITY TASK FORCE THOUGHTS SINCE LAST MEETING

- Tour Feedback
  - Reactions from the tour?
  - Feedback and observations?
- Prior Key Messages:
  - Made good progress on advancing need statements.
  - Conceptual drawings were viewed to demonstrate what could be done to update buildings.
  - Reassuring that needs statements were crossing multiple categories.





### Need Statements: Repairs:

- *We need our publicly used facilities to be maintained at a consistently high quality standard.*
- *Currently, we have needs for replacement of many exterior envelope systems, finishes, HVAC and electrical systems across our buildings. **Some systems are 90+ years old, the middle school is 20 years old, and all require significant maintenance.***
- *The current State funding source for facility maintenance allows us to spend about \$1,000,000 a year on maintenance related projects as well day to day operations. This funding **alone is not viable to keep up with all our maintenance needs. It is also tied to enrollment and may possibly decline in the future.***
- *We need to recognize that repair needs will continue through the years and plan spending accordingly.*

## Need Statements: District Organization

- *We have additional space in our buildings that would allow us to accommodate other needs:*
  - *Pre-school program growth and planning for Universal Pre-K programming*
  - *Community Education use of facilities*
  - *Community use of facilities (space rental)*
  - *Special education space*
  - *District Office / Miller Mentoring etc.*
- *Grade reconfiguration is also a possibility based on available space.*
- ***The District should optimize operational cost of facilities to create efficient and effective education.***
- ***We need to prioritize reconfiguring needs with a focus on educational needs.***
- ***We need to think big and for the future.***

## Need Statements: Public Perception (Proposal):

- ***The Community needs to understand that engaging the community in our programming benefits our students.***
  - *Business partnerships and other institutions*
  - *Tailoring our curriculum to meet the needs of our community businesses.*
  - ***Classes that include more career immersion opportunities with our local business partnerships and other institutions.***
- ***Buildings should be perceived as welcoming and easily accessible to all community members, especially those with identified disabilities.***
- ***The community needs to better understand our buildings are not meeting all of our needs.***
- ***The community needs to understand school finances are not sufficient for facilities.***

## Need Statements: Program Needs and Updates

- *Currently, our gym space is scheduled heavily in the winter and spring months causing many students to have very early or very late practices and activities.*
- *Our support spaces to our activity spaces are outdated and inequitable.*
  - *Examples of this are the locker rooms and fine art spaces.*
- ***Specialist spaces are outdated and inequitable. Examples are basement specialists, auditoriums, locker rooms, etc.***
- ***There is a need to expand athletic and activity spaces to provide equitable access to all students and community members in order to meet health and wellness requirements.***
- ***We need to advance the CTE spaces to prepare students for careers in our community.***



### Need Statements: Program Needs and Updates

- *We need flexible/multiple-use spaces to meet the needs of all learners and educators.*
- *We need to be sure that grade configurations support a maximized growth and change in 21<sup>st</sup> century learning. (e.g. needs are different in different grades)*
- ***Pre-K should be part of a continuous experience in our district.***
  - ***Alignment of pre-k with elementary programs.***
- ***Programs should be accessible to all students.***





## Need Statements: Accessibility

- *Every student, staff member, and community member needs equitable access to our facilities.*
- *Currently, we have accessibility challenges at the elementaries and the high school including access to all instructional use spaces and building entries.*



# DISCUSSION QUESTIONS

### What will your community support?

1. Is it viable to have less students in the elementary schools?
2. Can we have less attendance centers than we do now?
3. Are we comfortable with more transitions than we have now?
4. Planning for an enrollment projection:
  - a. 2,000 students - slightly higher than the projections we saw.
  - b. School board is considering enrollment through the FY2023 budget assumptions.



# OPTIONS DISCUSSION



## COMMUNITY TASK FORCE OPTIONS DISCUSSION

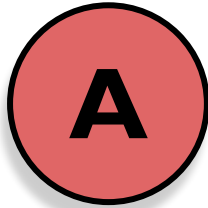

### Investments at each facility

- PK-4 @ each elementary
- Renovation / Addition

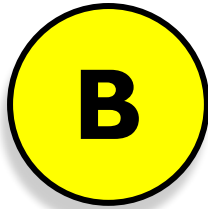

### Replace 1 elementary school

- PK-4 @ each elementary
- Renovation / Addition
- Close 1 ES & Build 1 new

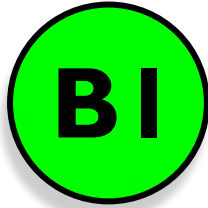

### Replace all elementary schools

- Close All ES & Build 1 new

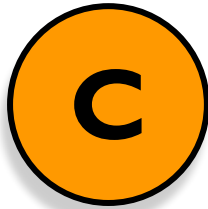

### Paired Buildings

- PK-K / 1 - 2 / 3 -4 @ ES
- Renovation / Addition

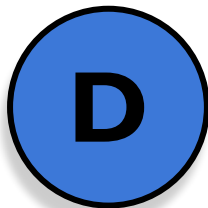

### Primary Centers

- PK-3 @ each ES
- Renovation / Addition
- 4th Grade to MS

***Note: Improvements at ALC, Middle School, High School and Paul Giel Field are the same in each option.***



## Current Configuration - 2021/2032 Enrollment

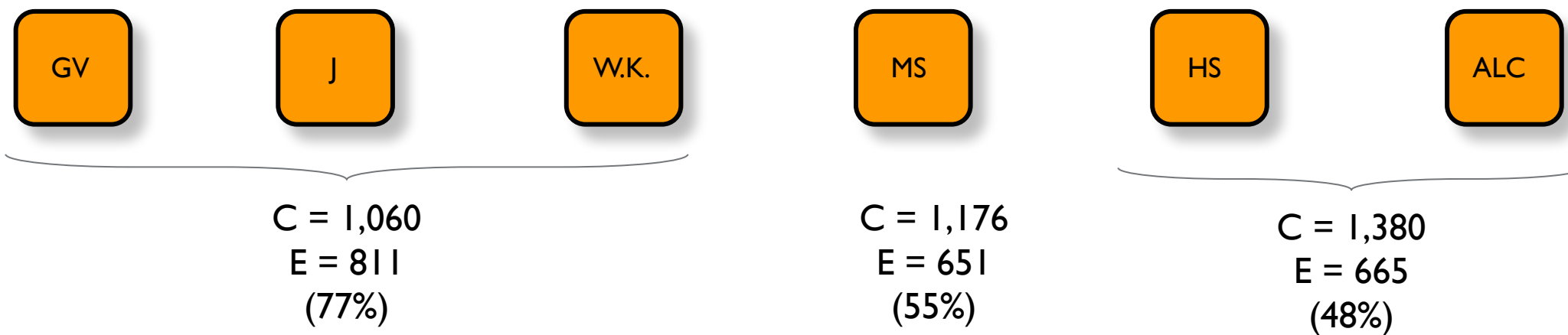

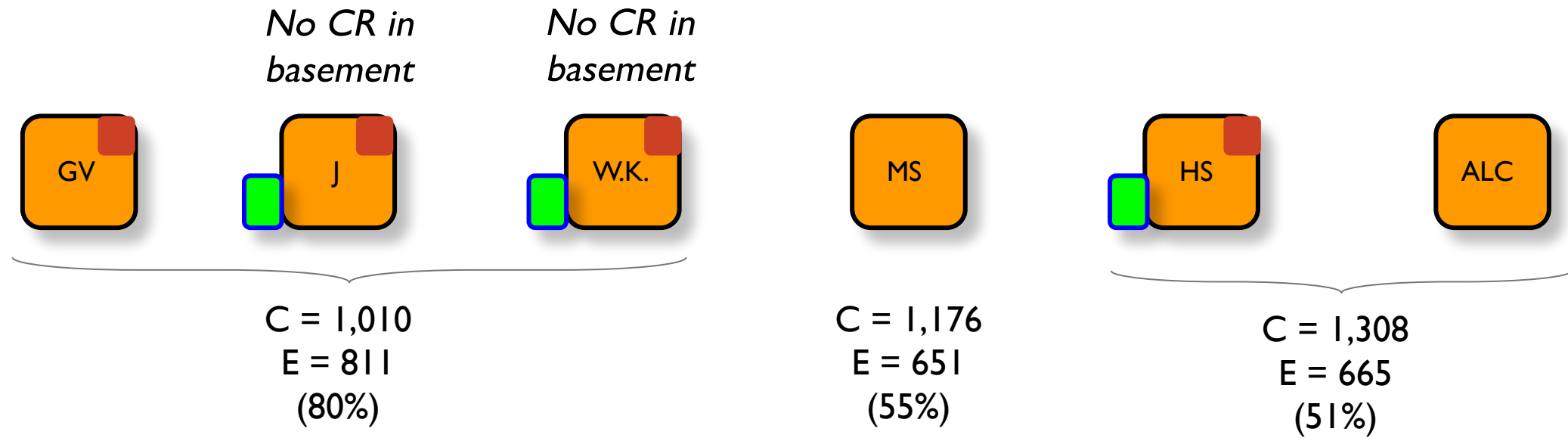

## Investments at each facility

- PK-4 @ each elementary
- Renovation / Addition



Proposed  
Addition



Proposed Flex Space /  
Classroom Renovation



## COMMUNITY TASK FORCE OPTIONS DISCUSSION



### Goodview ES

- Light Remodel on CR and Common Areas
- Flexible Walls
- Furniture Throughout

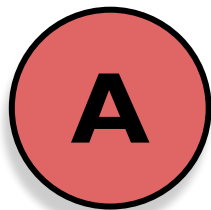

### Investments at each facility

- PK-4 @ each elementary
- Renovation / Addition



## COMMUNITY TASK FORCE OPTIONS DISCUSSION

### Jefferson ES

- Light Remodel on CR's
- Heavy Remodel to create Flex Areas
- Cafeteria/Student Service Addition
- Flexible Walls
- Furniture Throughout

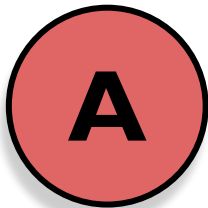
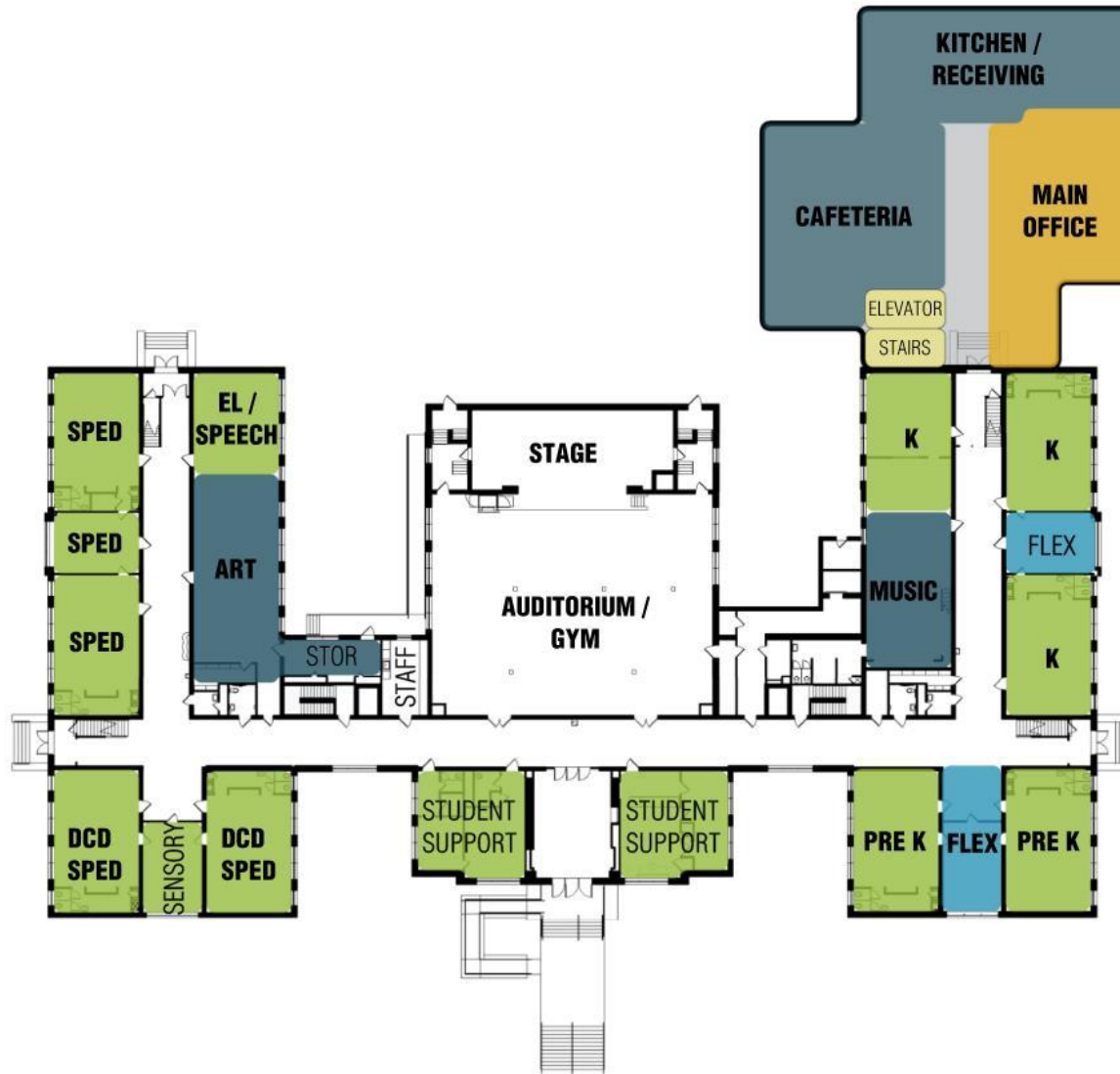

### Investments at each facility

- PK-4 @ each elementary
- Renovation / Addition

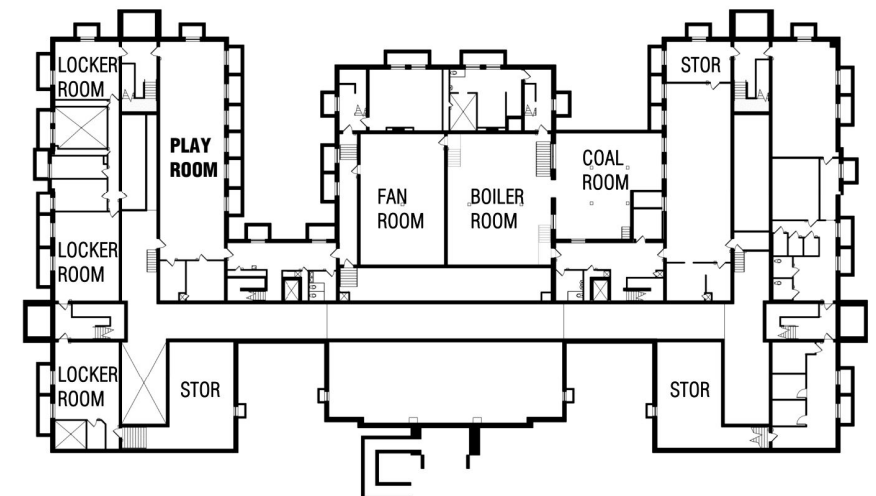



## COMMUNITY TASK FORCE OPTIONS DISCUSSION

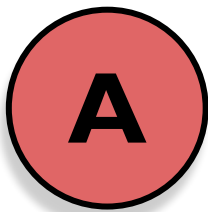

### Investments at each facility

- PK-4 @ each elementary
- Renovation / Addition







## COMMUNITY TASK FORCE OPTIONS DISCUSSION

### Washington Kosciusko ES

- Light Remodel on CR's
- Heavy Remodel to create Flex Areas
- Cafeteria/Student Service Addition
- Flexible Walls
- Furniture Throughout

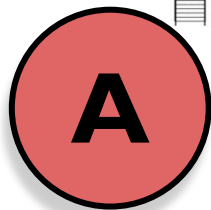

### Investments at each facility

- PK-4 @ each elementary
- Renovation / Addition

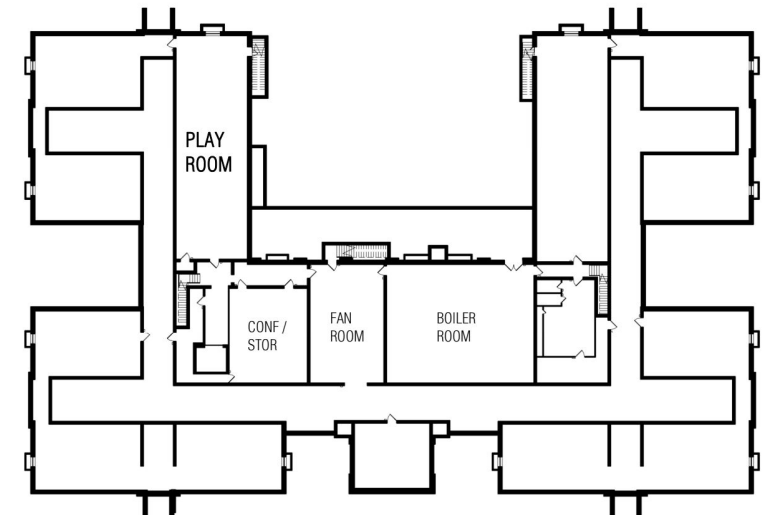



## COMMUNITY TASK FORCE OPTIONS DISCUSSION

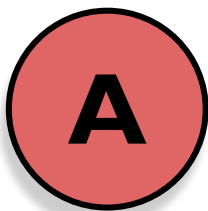
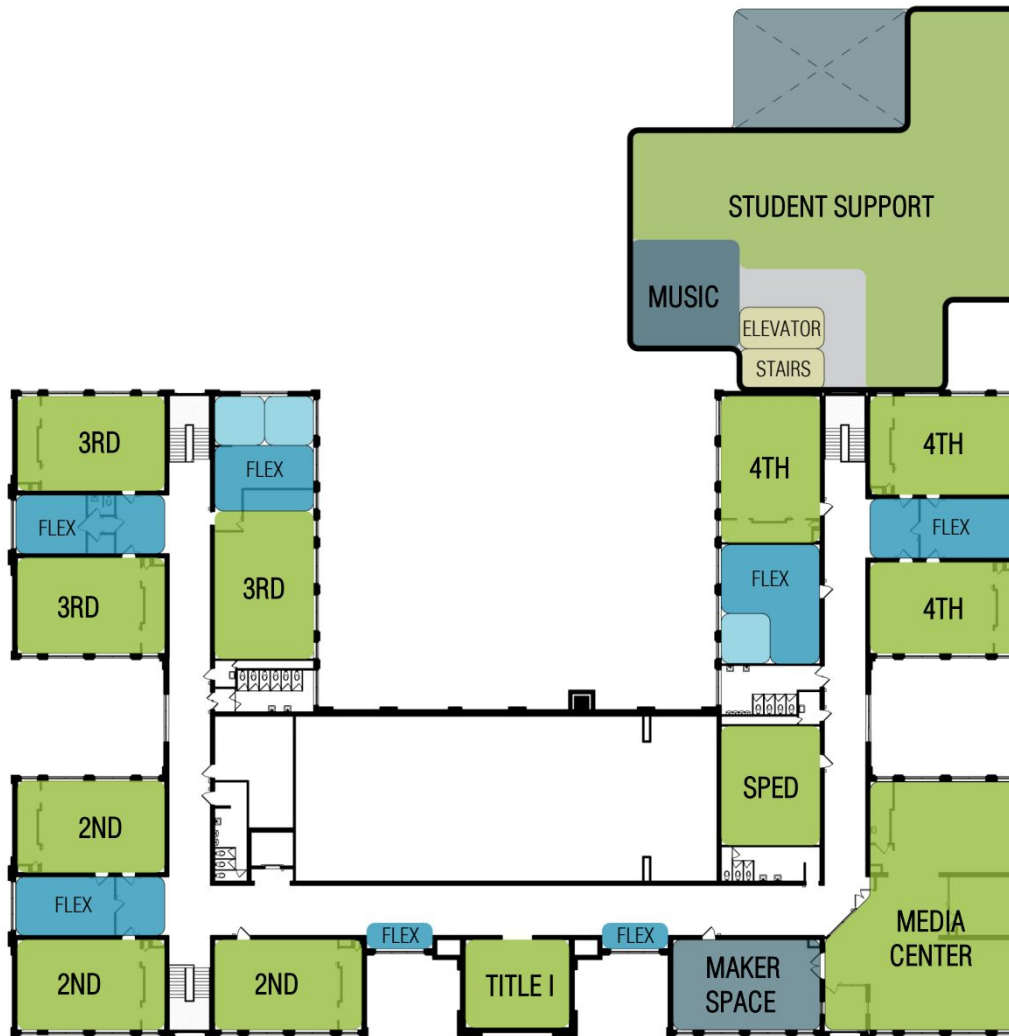

### Investments at each facility

- PK-4 @ each elementary
- Renovation / Addition

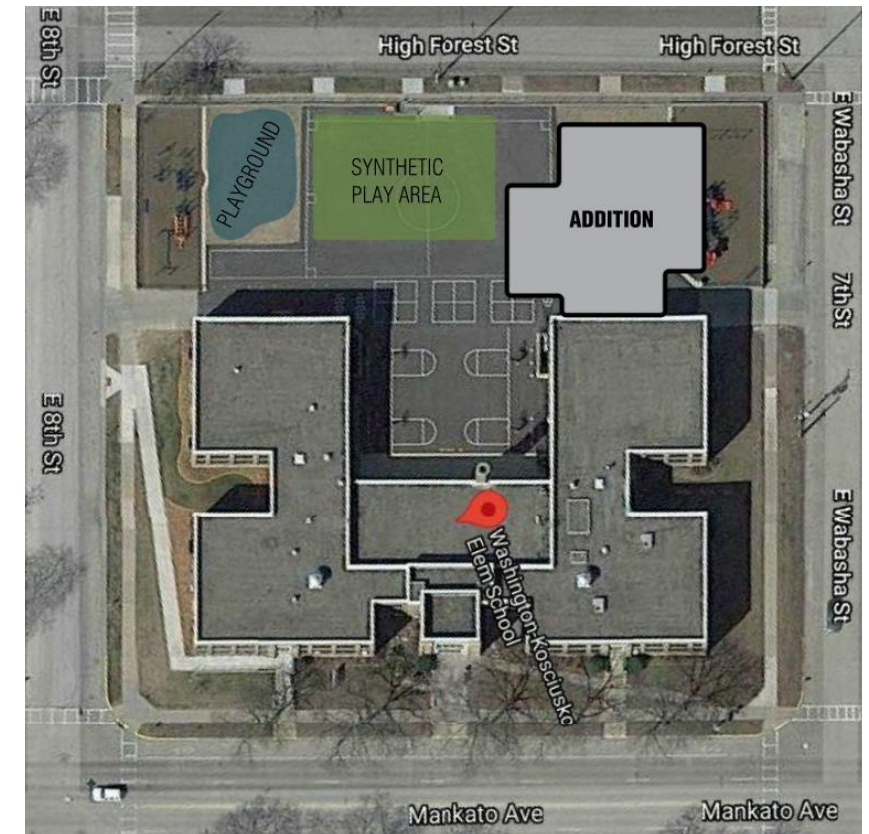



## COMMUNITY TASK FORCE OPTIONS DISCUSSION



### High School

- Light Remodel on CR's
- Heavy Remodel to create Flex Areas
- Heavy Remodel on CTE, Fine Arts CR's and FACS
- Gym and Locker Room Addition
- Flexible Walls
- Furniture Throughout
- Does not include Kolter Wing





# COMMUNITY TASK FORCE OPTIONS DISCUSSION



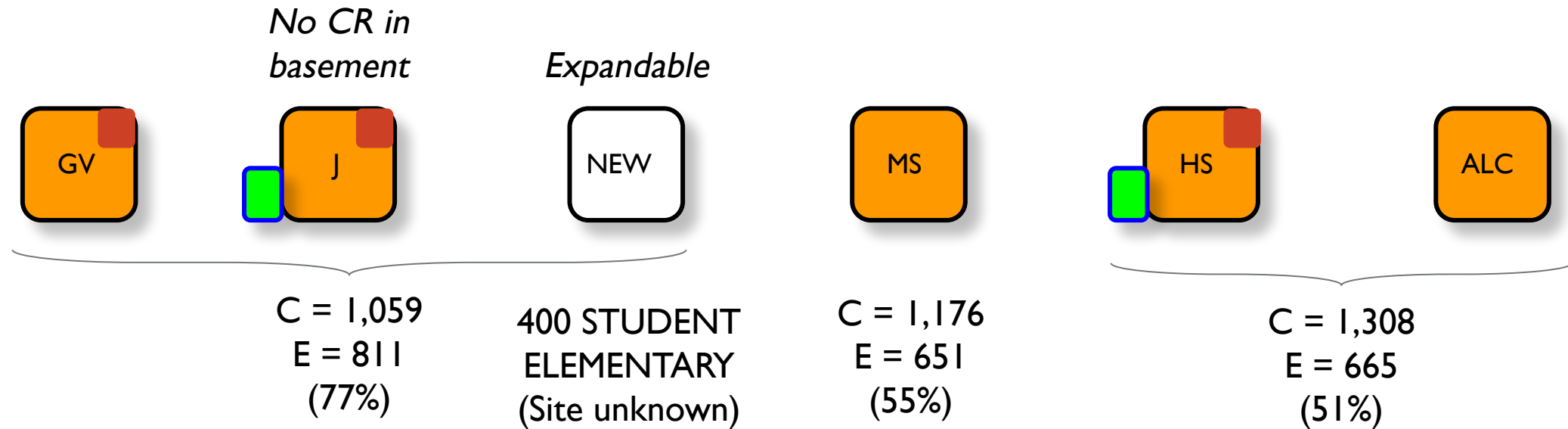

## Replace 1 elementary school

- PK-4 @ each elementary
- Renovation / Addition
- Close 1 ES & Build 1 new



Proposed  
Addition



Proposed Flex Space /  
Classroom Renovation



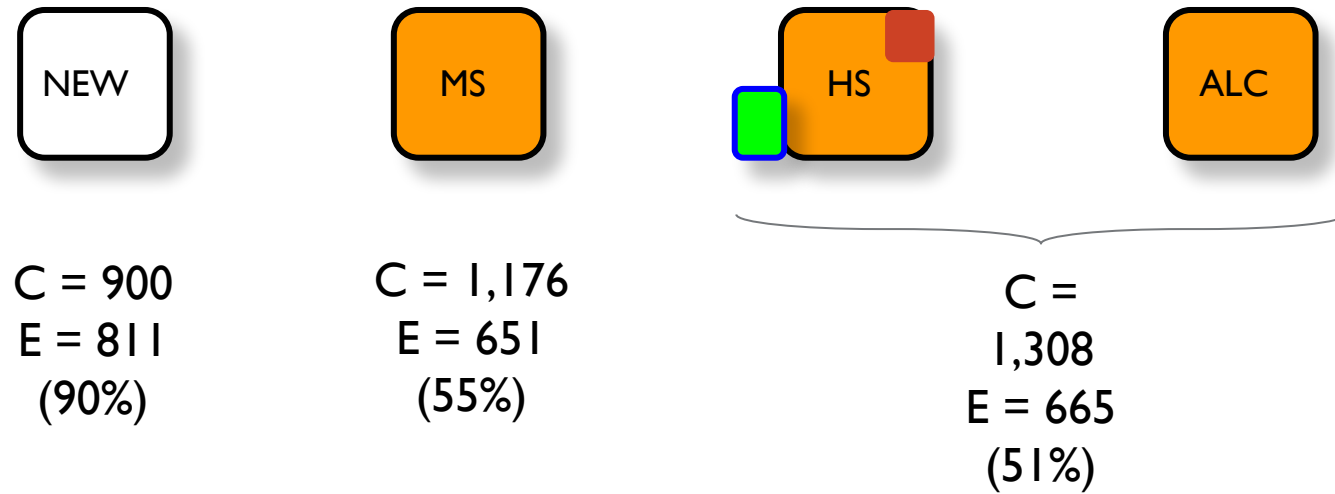

## Replace all elementary schools

- Close All ES & Build 1 new



Proposed Addition



Proposed Flex Space /  
Classroom Renovation

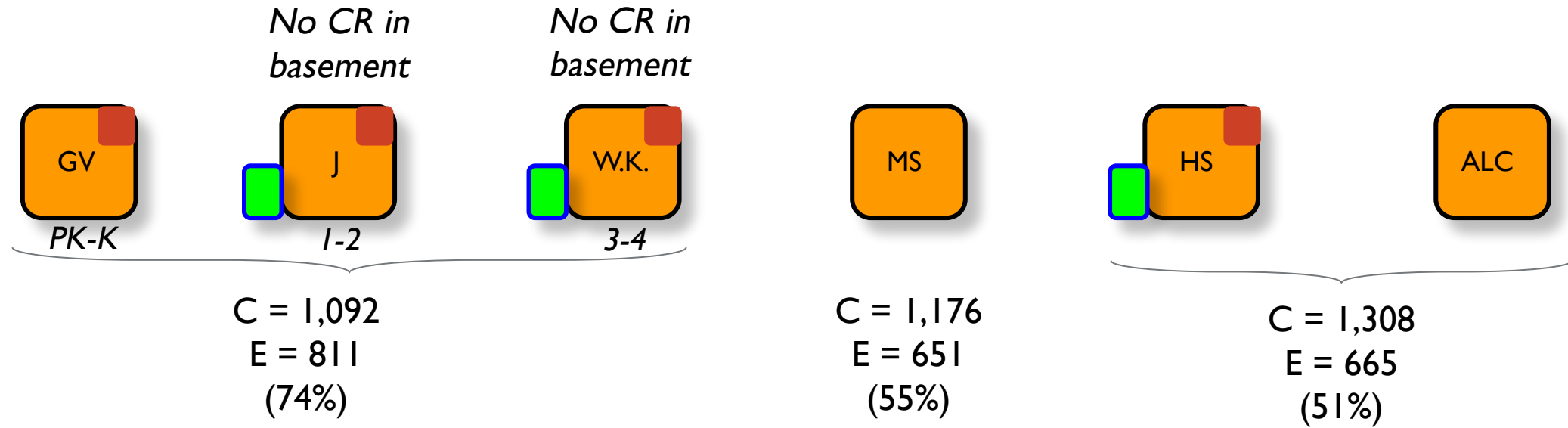

## Paired Buildings

- PK-K / 1 - 2 / 3 -4 @ ES
- Renovation / Addition



Proposed  
Addition



Proposed Flex Space /  
Classroom Renovation

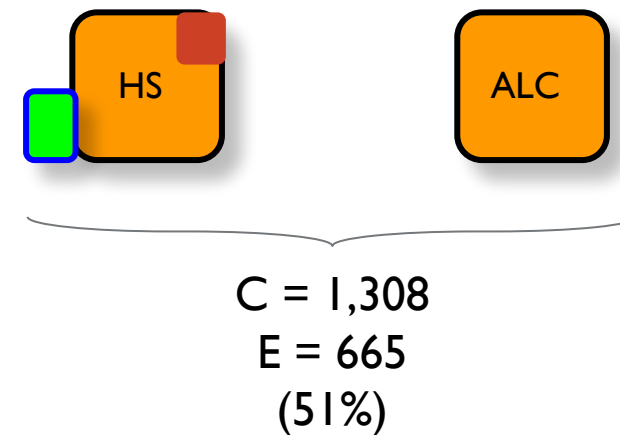
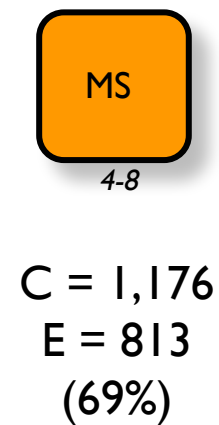
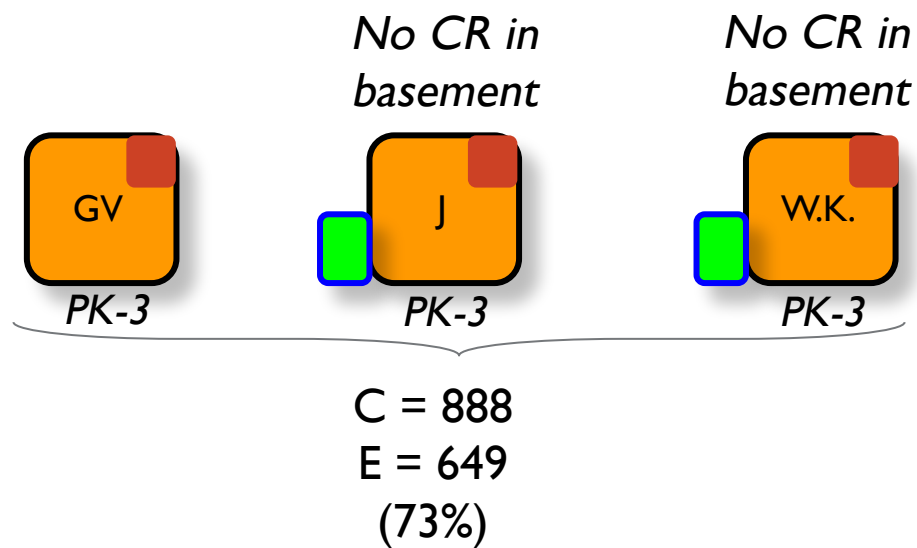

## Primary Centers

- PK-3 @ each ES
- Renovation / Addition
- 4th Grade to MS



Proposed  
Addition



Proposed Flex Space /  
Classroom Renovation



1. What are the advantage/disadvantage of each option?
2. Is there one or two you would eliminate?
3. Are there options missing that should be tested?



# KEY MESSAGES

*What key messages do you want to share about our meeting today?*





### **HOMEWORK:**

Talk to your neighbors, peers, colleagues about this committee. Bring back any relevant feedback to the next meeting!

### **NEXT MEETING:**

February 9, 2022 @ 5:30 pm (ALC then Jefferson ES)

